

1880ECM1-25

25 PAIR - INDOOR BET - MS2/110 - SPLICE CHAMBER & NO COVER



Product Specifications

UL497 Primary Protector for Communication Circuits

NAFTA Country of Origin: CANADA - All Models are "Buy America Act" Approved.

These 16 AWG steel building entrance terminals feature an easy to install MS2 style connector for use in specialized OSP installations including ONU and FTTx and military command and control centers. Also included are multiple external and internal ground lugs as well as a splice chamber. UL Approval standard on all terminals. Standard 5-pin protector modules, available in gas tube and solid state versions, are sold separately.

Features & Benefits

- 16 AWG Powder Coated Steel Construction
- Equipped with an Internal 26 AWG Fuse Link
- External Ground Connectors Accept 6 - 14 AWG Wire
- Industry Standard 5 Pin Design
- Exceeds UL497 Primary Protection Standards
- Stackable with Connection Grommets Included
- MS2 Input Accepts 22 - 28 AWG Wire/110 Output Accepts 22- 26 AWG Wire

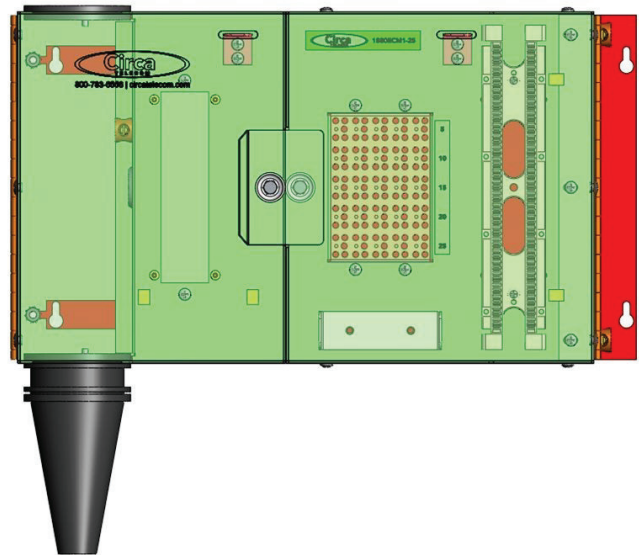

1880ECM1-25

Ordering Information

Model Number	Stock Code	Pair Count	Input	Output	Dimensions (H" x W" x D")	Weight (lbs)
1880ECM1-25	305007	100	MS2	110	7.50 x 11.50 x 5.25	8

1880ECM1-25

25 PAIR - INDOOR BET - MS2/110 - SPLICE CHAMBER & NO COVER



Underwriters
Laboratories

Physical Dimensions

UL497 Primary Protector for Communication Circuits

7.50 x 11.50 x 5.25
(H" x W" x D")

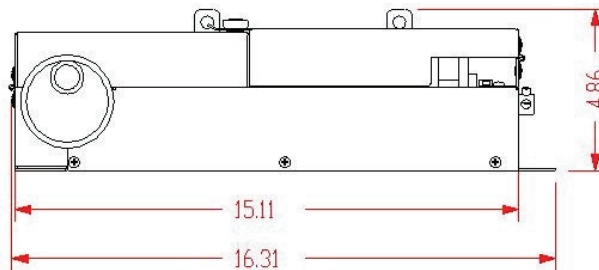
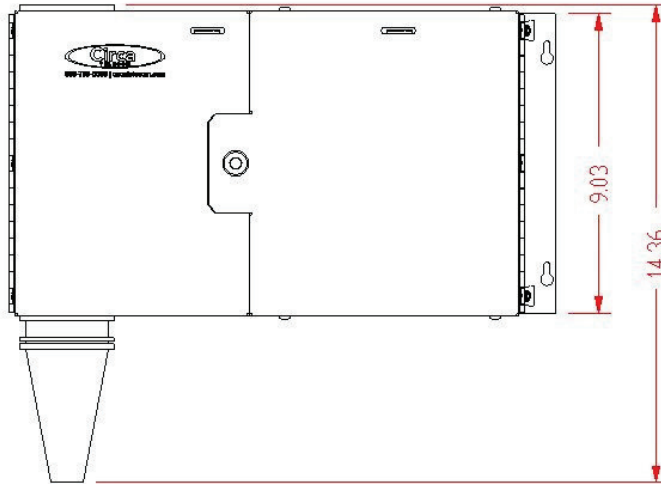

Notes

Installation:

Indoor Wall Mount

RUS Approved Material - 2011 Edition RUS Publication 344-2 (Section 4.1.2 and 4.2)